

WE **DESIGN** AND  
**MANUFACTURE**  
**BEAUTIFUL** DOOROS & SYSTEMS...



simple but not simple  
[gritaa-systems.com](http://gritaa-systems.com)



SCAN ME!



# ABOUT US

gritaa systems is a designers and manufacturers of Bespoke Steel Doors, Partitions, Windows and other beautiful interior systems. With a focus on High End Residential development, architectural projects and Commercial Fit-out projects. We Design, Manufacture and Install our doors bespoke for every project. We can support any project either a private client, project manager, property developer, architect or construction company then get in touch to find out how we can assist in your next project. The quality of our doors and windows goes far beyond how they look. To really get a feel for the quality craftsmanship that makes gritaa systems so special, you need to come and experience for yourself.

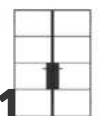

**more than  
design is  
passion...**

# Glazing beads



Premium line



Smart line

The modern loft door glass rails are available in two versions: the Slim glazing beads give the doors a particularly narrow and elegant look with a viewed width of only 15 mm, while the angled glazing beads authentically emphasise the industrial style with their visible screw fittings.

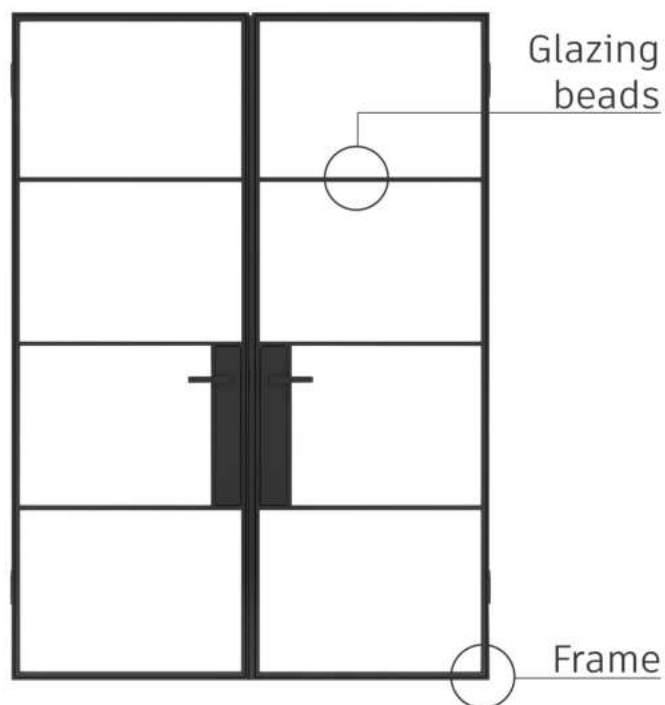

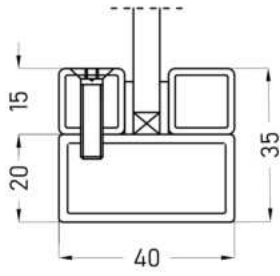

FRAME  
CLASSIC



## The classic

The specially designed shape of our profiles, combined with the highest quality galvanised steel with just a 20mm steel profile, has allowed us to produce exceptionally thin door frames without compromising on durability and stability, lasting for decades.

FRAME  
CLASSIC+

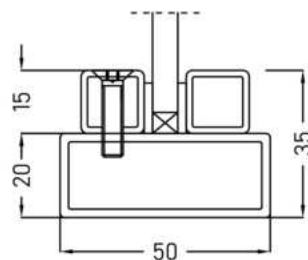

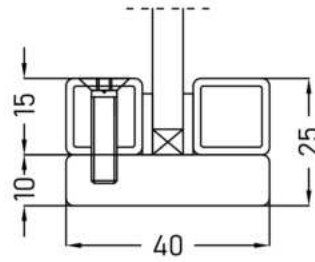

## FRAME SLIM

### The elegant

With the unlimited options of design, screens allow to open up even the biggest spaces letting in the natural light flow between rooms. Often incorporated to design a seamless transition and to achieve spaciousness. With advanced technology, steel is robust enough to support the biggest glass panes.

## FRAME SLIM+

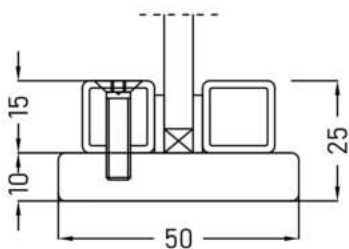

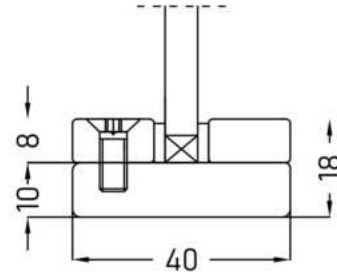

## FRAME ULTRA SLIM

### Minimal Steel | Maximum Glass

Unique to gritaa systems, we have carefully designed our Profiles to create some of the slimmest sightlines in the industry, giving you a sophisticated, clean look that maximizes natural light:

## FRAME ULTRA SLIM+

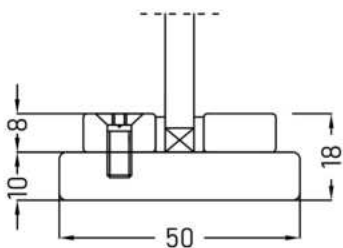

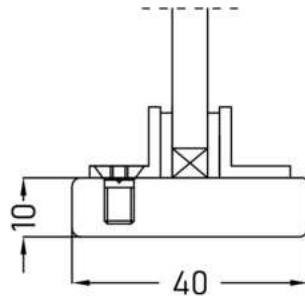

## FRAME SLIM L-Line

### Timeless

Timelessly elegant, our Slim L-Line inspiration from the industrial aesthetic to give your home a touch of classic sophistication. With options ranging from single steel doors to double doors, there's no limit to discovering your perfect look.

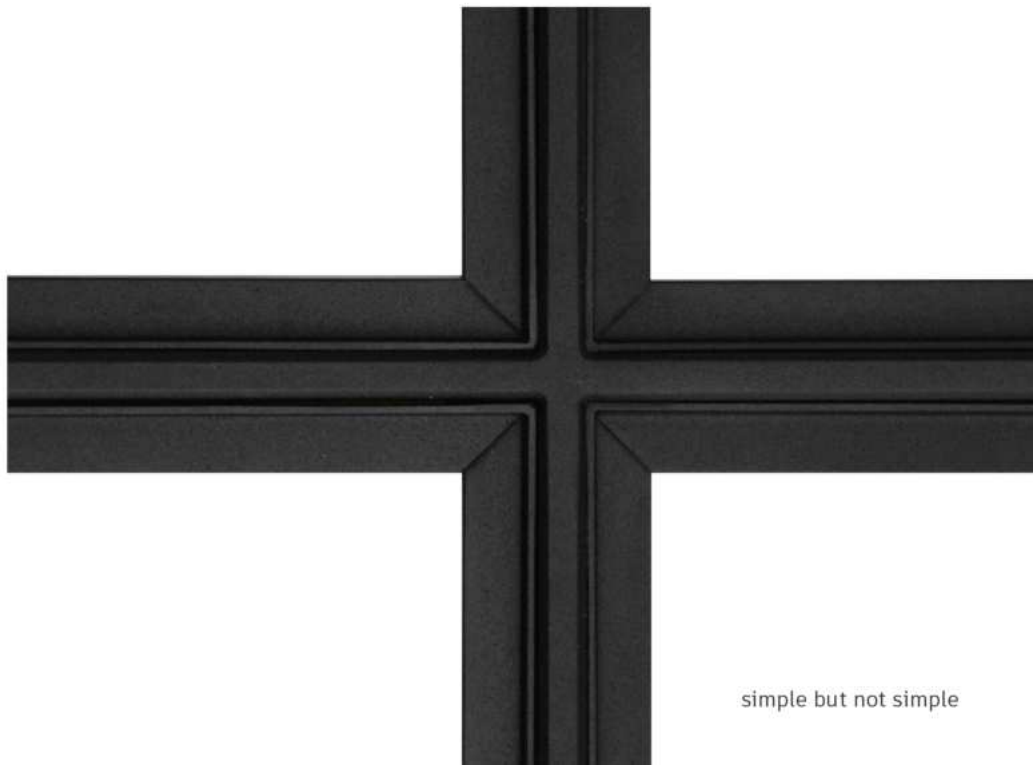



## Durability

Thanks to the exceptionally durable and stable structure of the door's frame and wings made of steel, one chamber (without a thermal barrier with a wall thickness of 1,5mm) with welded and ball-bearing hinges, door will serve you for many years. High quality materials guarantee excellent resistance to any kind of damage.

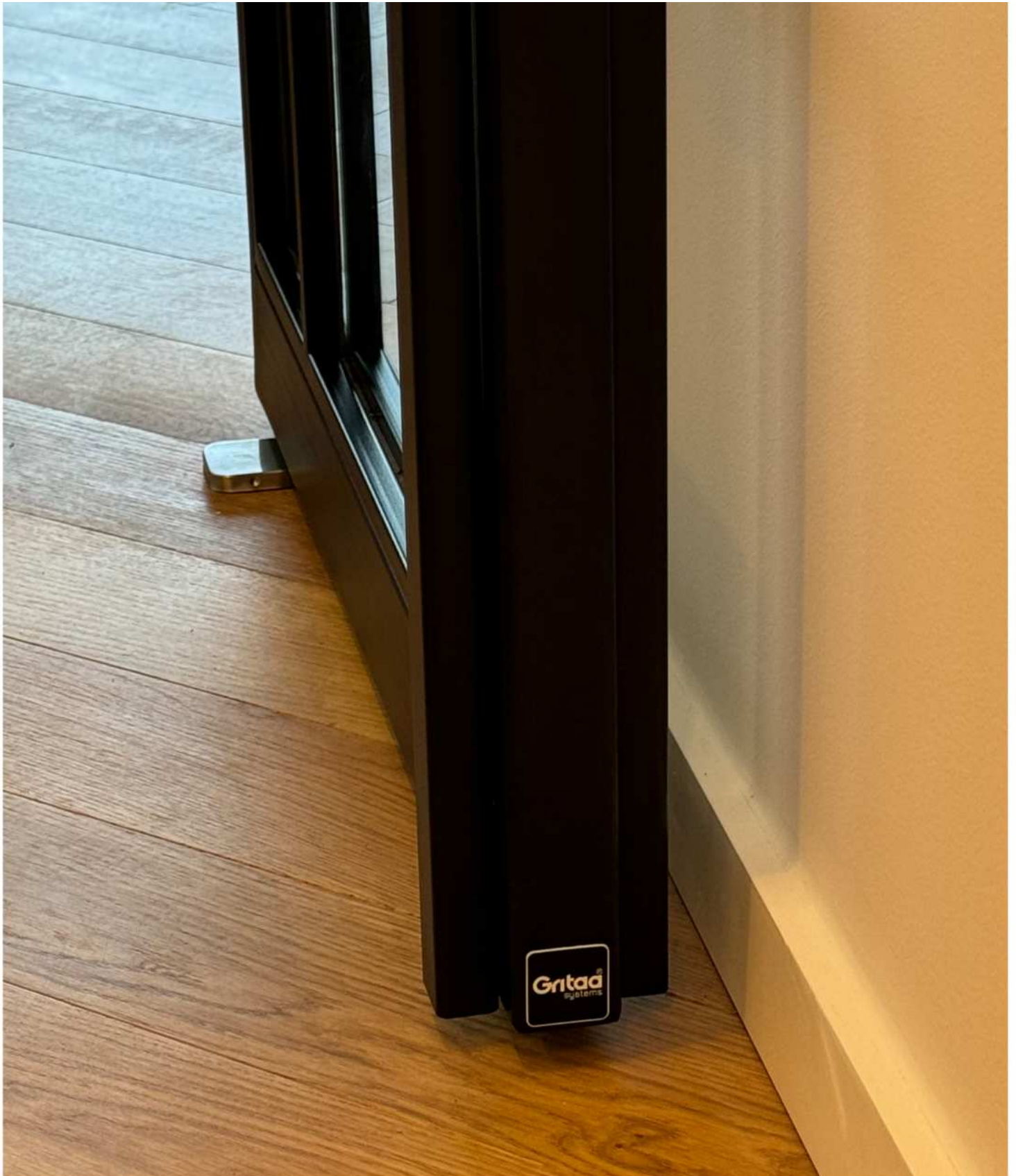

SINGELDEUR

01



# versions / sizes

## Single-leaf doors - Standard

Width\* 650-1200mm  
Height \* 1900-3000mm



**MODEL 1 - S**  
without horizontal and vertical rails  
available for SMART & PREMIUM line



**MODEL 2 - S**  
with a horizontal rail  
available for SMART & PREMIUM line



**MODEL 3 - S**  
with 2 horizontal rails  
available for SMART & PREMIUM line



**MODEL 4 - S**  
with 2 horizontal rails and a vertical rail  
available for PREMIUM line

# Versions / sizes

## Single-leaf doors - Standard

Width\* 650-1200mm  
Height \* 1900-3000mm



**MODEL 5 - S**  
with 3 horizontal rails  
available for SMART & PREMIUM line



**MODEL 6 - S**  
with 2 horizontal rails and a vertical rail  
available for PREMIUM line



**MODEL 7 - S**  
available for PREMIUM line



**MODEL 8 - S**  
available for PREMIUM line



# Versions / sizes

Single-leaf and sliding doors - Exclusiv

Width\* 650-1200mm  
Height \* 1900-3000mm



MODEL 1E - S  
available for PREMIUM line



MODEL 2E- S  
available for PREMIUM line



MODEL 3E - S  
available for PREMIUM line



MODEL 4E - S  
available for PREMIUM line

# SINGLE DOOR + SIDE ELEMENT



# 02

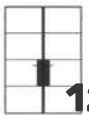

12

gritaa-systems

simple but not simple

# Versions / sizes

Single-leaf door + side element - Standard

Door width\* 650-1200mm  
Door height\* 1900-3000mm

Side element Width\* 300-1250mm  
Side element Height\* 1900-3000mm



**MODEL 1 - SE**  
without horizontal and vertical rails  
available for SMART & PREMIUM line



**MODEL 2 - SE**  
with a horizontal rail  
available for SMART & PREMIUM line



**MODEL 3 - SE**  
with 2 horizontal rails  
available for SMART & PREMIUM line



**MODEL 4 - SE**  
with 2 horizontal rails and a vertical rail  
available for SMART & PREMIUM line

# Versions / sizes

Single-leaf door + side element - Standard

Door width\* 650-1200mm  
Door height\* 1900-3000mm

Side element Width\* 300-1250mm  
Side element Height\* 1900-3000mm



**MODEL 5 - SE**  
with 3 horizontal rails  
available for SMART & PREMIUM line



**MODEL 6 - SE**  
with 2 horizontal rails and a vertical rail  
available for PREMIUM line



**MODEL 7 - SE**  
available for PREMIUM line



**MODEL 8 - SE**  
available for PREMIUM line

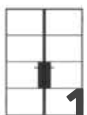





# SIMPLE BUT NOT SIMPLE

# DOUBLE DOOR

# 03

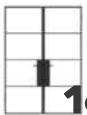

# Versions / sizes

Double-leaf door - Standard

Door width\* 1250-2500mm  
Door height\* 1900-3000mm



**MODEL 1 - D**  
without horizontal and vertical rails  
available for SMART & PREMIUM line



**MODEL 2 - D**  
with a horizontal rail  
available for SMART & PREMIUM line



**MODEL 3 - D**  
with 2 horizontal rails  
available for SMART & PREMIUM line



**MODEL 4 - D**  
with 2 horizontal rails and a vertical rail  
available for PREMIUM line

# Versions / sizes

Double-leaf door - Standard

Door width\* 1250-2500mm  
Door height\* 1900-3000mm



**MODEL 5 - D**  
with 3 horizontal rails  
available for SMART & PREMIUM line



**MODEL 6 - D**  
with 2 horizontal rails and a vertical rail  
available for PREMIUM line

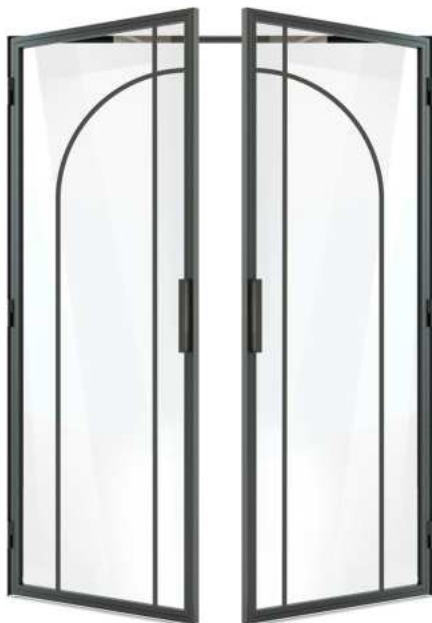

**MODEL 7 - D**  
available for PREMIUM line



**MODEL 8 - D**  
available for PREMIUM line



# BEAUTIFUL DOORS.

# SLIDING DOOR



# 04

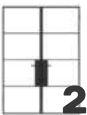

# Versions / sizes

## Sliding doors - Standard

Door width\* 650-1500mm  
Door height\* 1900-3000mm



**MODEL 1 - SL**  
without horizontal and vertical rails  
available for SMART & PREMIUM line



**MODEL 2 - SL**  
with a horizontal rail  
available for SMART & PREMIUM line



**MODEL 3 - SL**  
with 2 horizontal rails  
available for SMART & PREMIUM line



**MODEL 4 - SL**  
with 2 horizontal rails and a vertical rail  
available for PREMIUM line

# Versions / sizes

Sliding doors - Standard

Door width\* 650-1500mm  
Door height\* 1900-3000mm

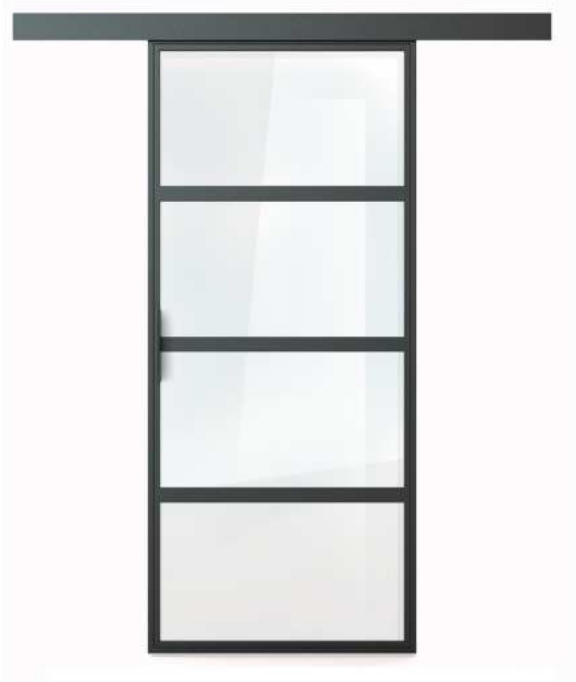

**MODEL 5 - SL**  
without horizontal and vertical rails  
available for SMART & PREMIUM line



**MODEL 6 - SL**  
with a horizontal rail  
available for SMART & PREMIUM line



**MODEL 7 - SL**  
with 2 horizontal rails  
available for SMART & PREMIUM line



**MODEL 8 - SL**  
with 2 horizontal rails and a vertical rail  
available for PREMIUM line



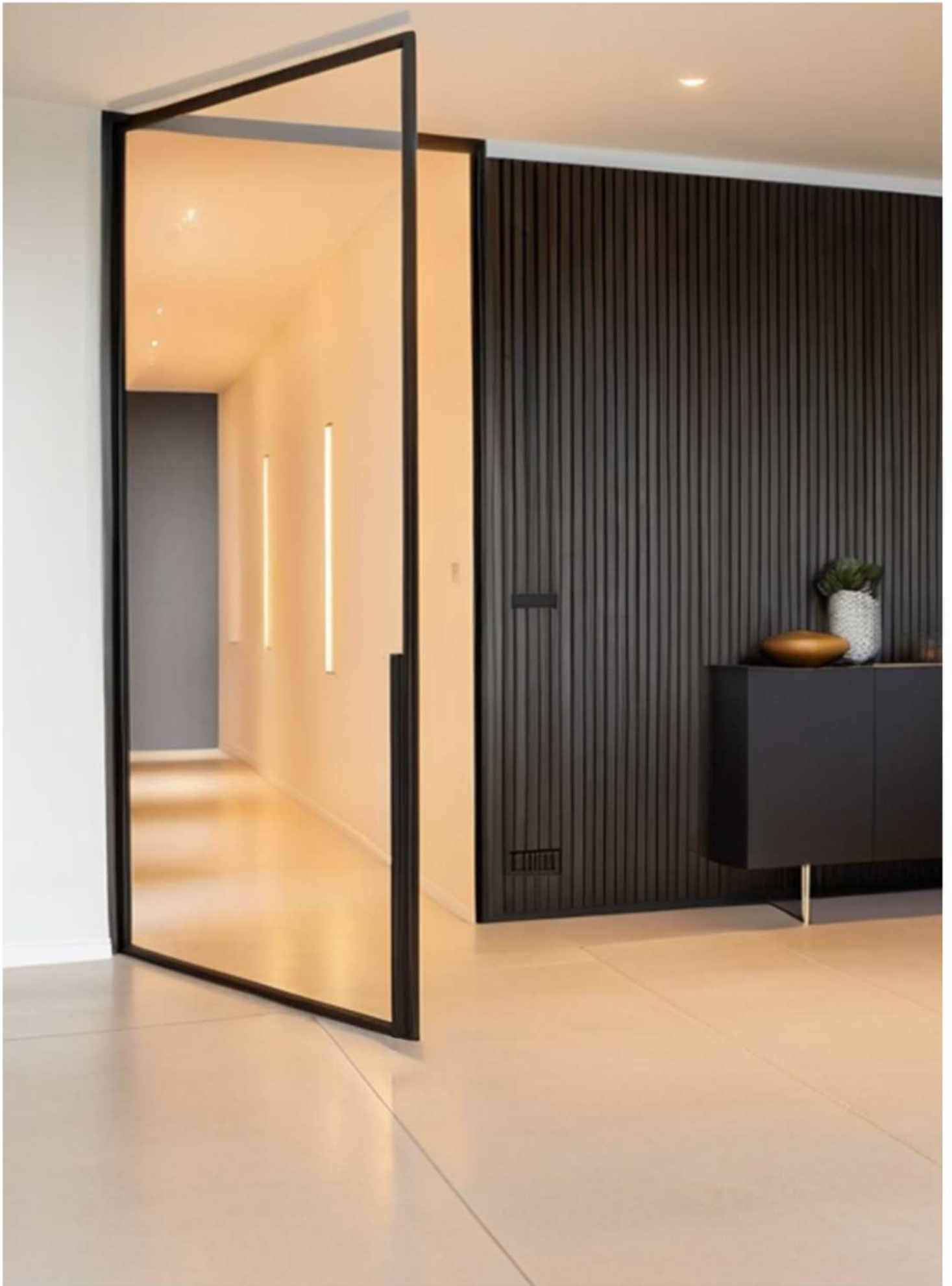

# PIVOT DOOR

# 05

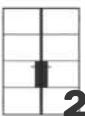

# We want to create more than just a door.

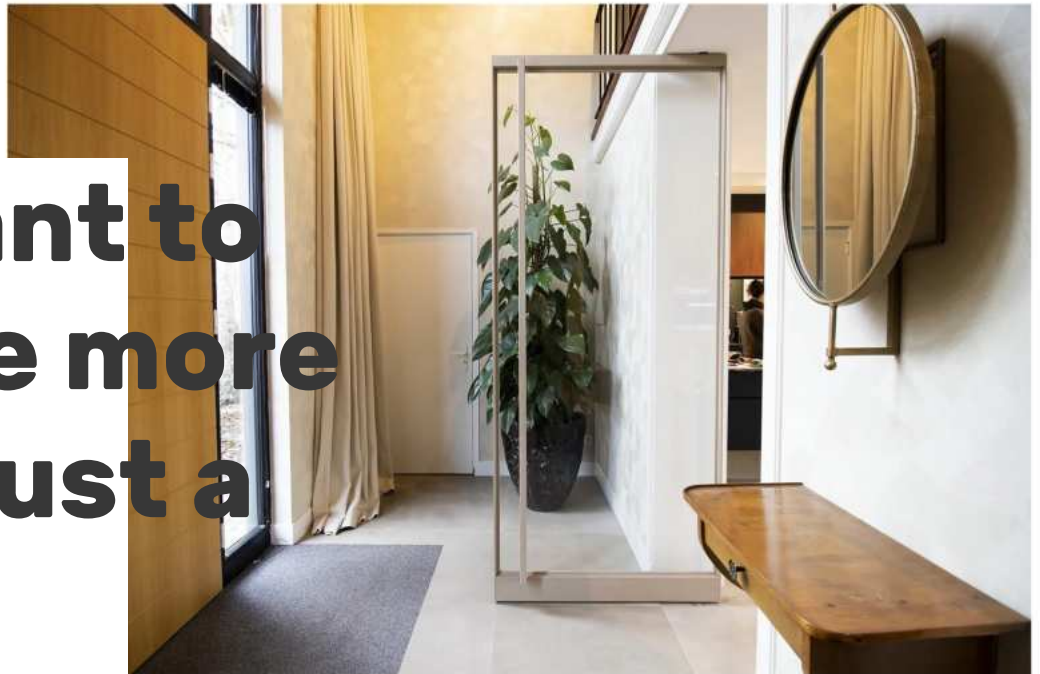

SUITABLE FOR DOORS BETWEEN 20 - 500 KG

## SYSTEM RANGE

System M+	20-500 kg
System M	20-210 kg
System 3	40-350 kg
System One	20-500 kg

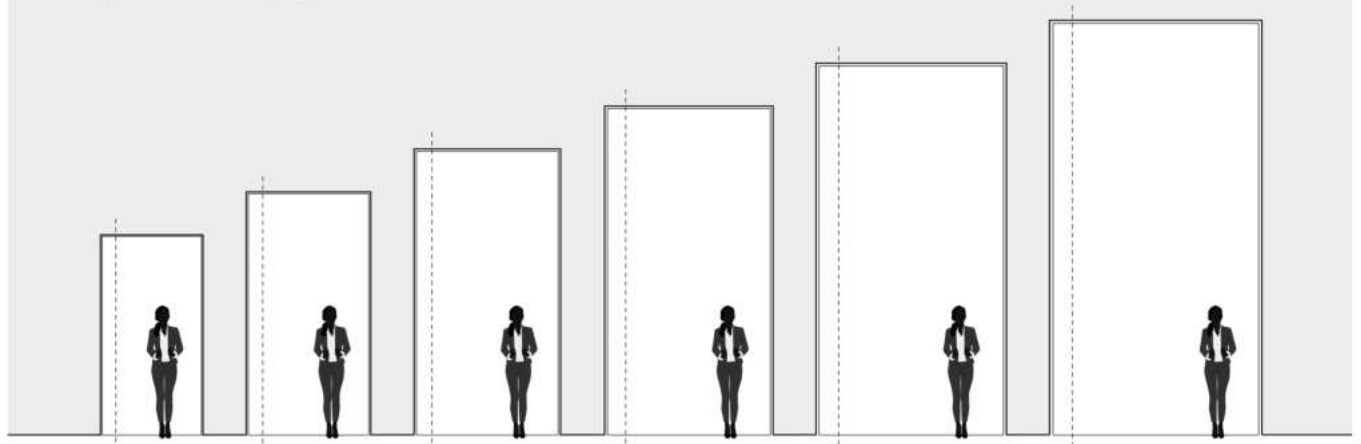

## FUNCTION

- Double-acting doors
- Rotation 180°
- Hold positions 90°, -90° and 0°
- Self-closing from 125° and -125° to 0°

## MOVEMENT

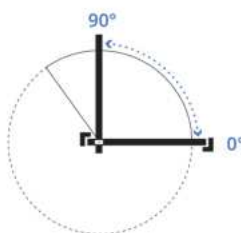
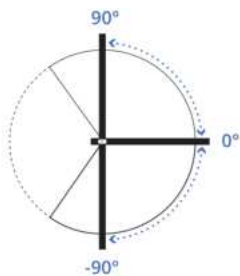

- Rotation 90°
- Hold positions 90° and 0°
- Self-closing from 125° to 0°

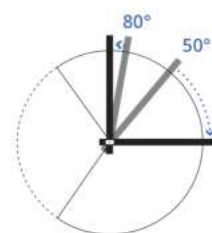

### Damper Control

Hydraulic backcheck (opening damping) for wall-protection, and soft-close.

# PREMIUM POWDER COATING

We understand the importance of colour in interior design. Gritaa systems offer Standard & Premium pallet of colours for an unlimited option of door design. Colours create harmony between rooms and allow you to create the atmosphere that you desire.

# COLORS

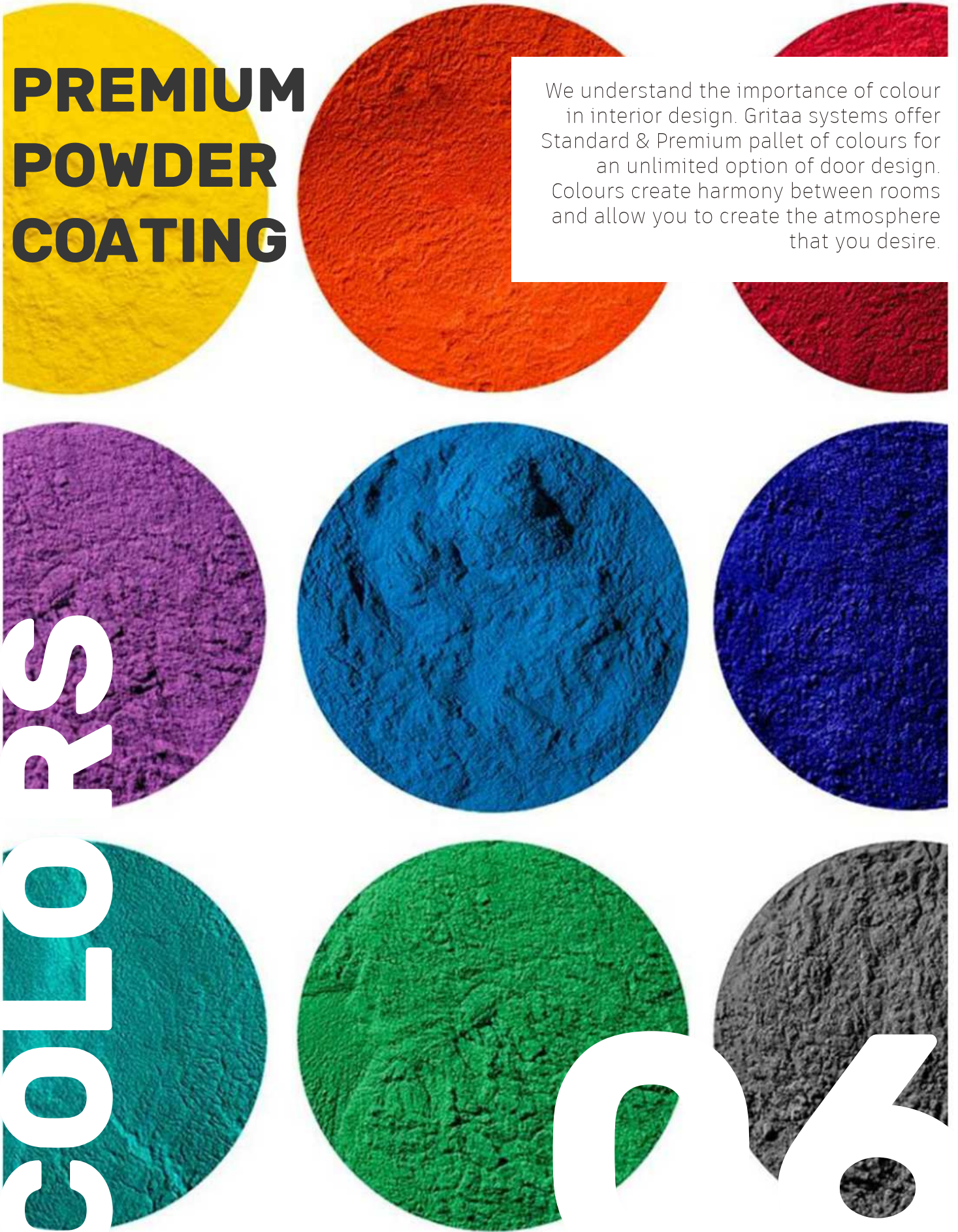

# Choosing Gloss & Texture



GLOSS



MATT

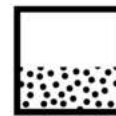

FINE  
STRUCTUR

## Standard colors

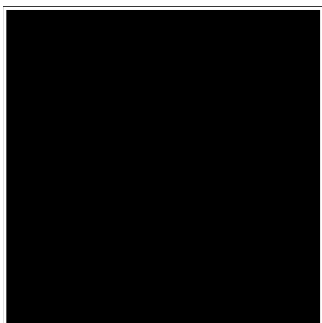

Deep black  
RAL 9005

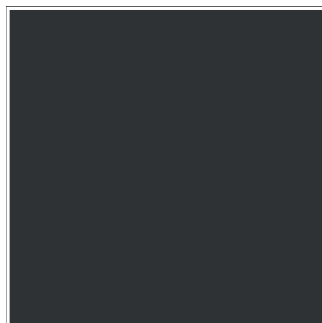

Black grey  
RAL 7021

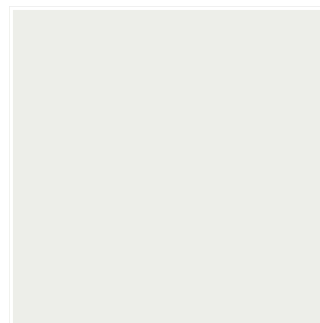

Signal white  
RAL 9003

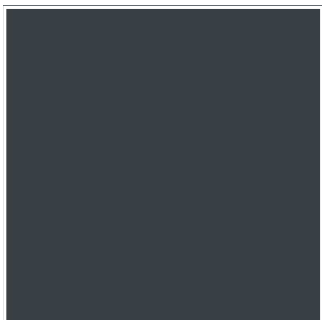

Anthracite grey  
RAL 9005



Other RAL colors

ALL RAL COLORS ARE AVAILABLE

# GLASS

**glass that  
reflects your  
vision...**

# 07



# Types of GLASS

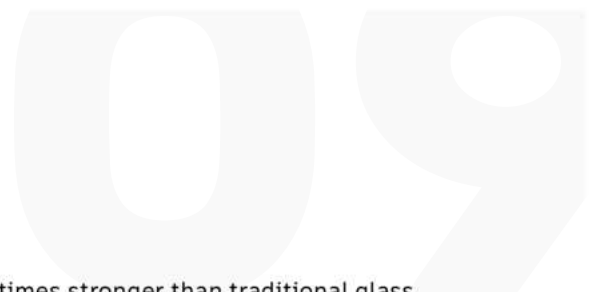

Tempered glass is anywhere between four to five times stronger than traditional glass. This toughness makes it harder to break. Should the glass break, it is engineered in a way where it will shatter into small pieces rather than large jagged edges



Laminated safety glass (VSG) is a laminated glass that meets safety requirements. During production, two individual panes are joined together with an intermediate layer – usually of PVB film – under the effect of pressure and heat to form a solid sandwich

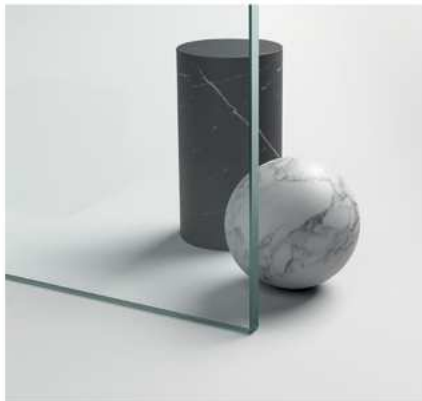

CLEAR  
VSG & ESG



MATT  
VSG & ESG



FLUTED  
VSG & ESG & DECO

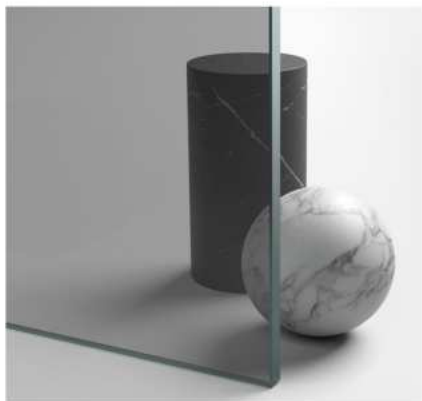

GRAY  
VSG & ESG



BLACK  
VSG & ESG



BROWN  
VSG & ESG

# LEVER HANDLE & PUSH BARS

PRODUCT OVERVIEW

# dnd







# The force of magnetic attraction.

PRODUCT COLOR OVERVIEW



**PVD-BG forte\***  
 Oro antico  
 lucido  
*Antique  
 bright gold*



**PVD-SG forte\***  
 Oro antico  
 satinato  
*Antique  
 satin gold*



**PVD-SH forte\***  
 Oro champagne  
 satinato  
*Champagne  
 satin gold*



**PVD-BB forte\***  
 Bronzo lucido  
*Bright bronze*



**PVD-SB forte\***  
 Bronzo satinato  
*Satin bronze*



**PGS forte\***  
 Grafite satinato  
*Satin graphite*



**OGH**  
 Bronzo satinato  
 opaco  
*Matte satin*



**OCS**  
 Cromo satinato  
*Satin chrome*



**OC**  
 Cromo lucido  
*Polished chrome*



**ONO**  
 Nero  
*Black*



**OBN**  
 Bianco  
*White*



**OSV**  
 Silver  
*Silver*

# DND LEVER HANDLE

PRODUCT OVERVIEW - in black



due



zeppelin



madeleine



boole



ginkgo biloba



ginkgo



timeless



C-1918



safety



short



edra 02



luxury



change B 02



project



project 02



(IN)finito



blip



intake



luce



luce 02



joy



joy 02



fold



fold 02



# LEVER HANDLE

## PRODUCT OVERVIEW



Also available:  
concealed hinges  
in velvet grey,  
graphite black,  
and cashmere grey

ONE BY GRIFFWERK stands for maximum reduction and is the programmatic front for the concept series ONE by GRIFFWERK. All functions have been condensed into one shape, escutcheons have been completely eliminated.



**R8 ONE**  
without escutcheon | White



**AVUS ONE**  
without escutcheon | Gold



**R8 ONE**  
without escutcheon | Velvet grey



**AVUS ONE**  
without escutcheon | Velvet grey



**R8 ONE**  
without escutcheon | Cashmere grey



**AVUS ONE**  
without escutcheon | Cashmere grey



**R8 ONE**  
without escutcheon | Graphite black



**AVUS ONE**  
without escutcheon | Graphite black

More handle options are available upon request

# BAR

\*STANDARD PUSH BAR



Adding bars to your door or window design is a great way to create an authentic traditional appearance. Despite their Georgian aesthetic, bars pair well with both classic and contemporary builds. Gritaa systems offers two beautiful bar styles so you can select the perfect finishing touch to complement your design.

STANDARD

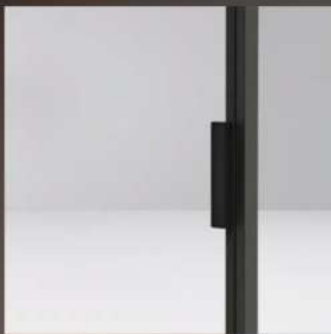

PREMIUM



PREMIUM MAXI



ELITE



More handle options are available upon request

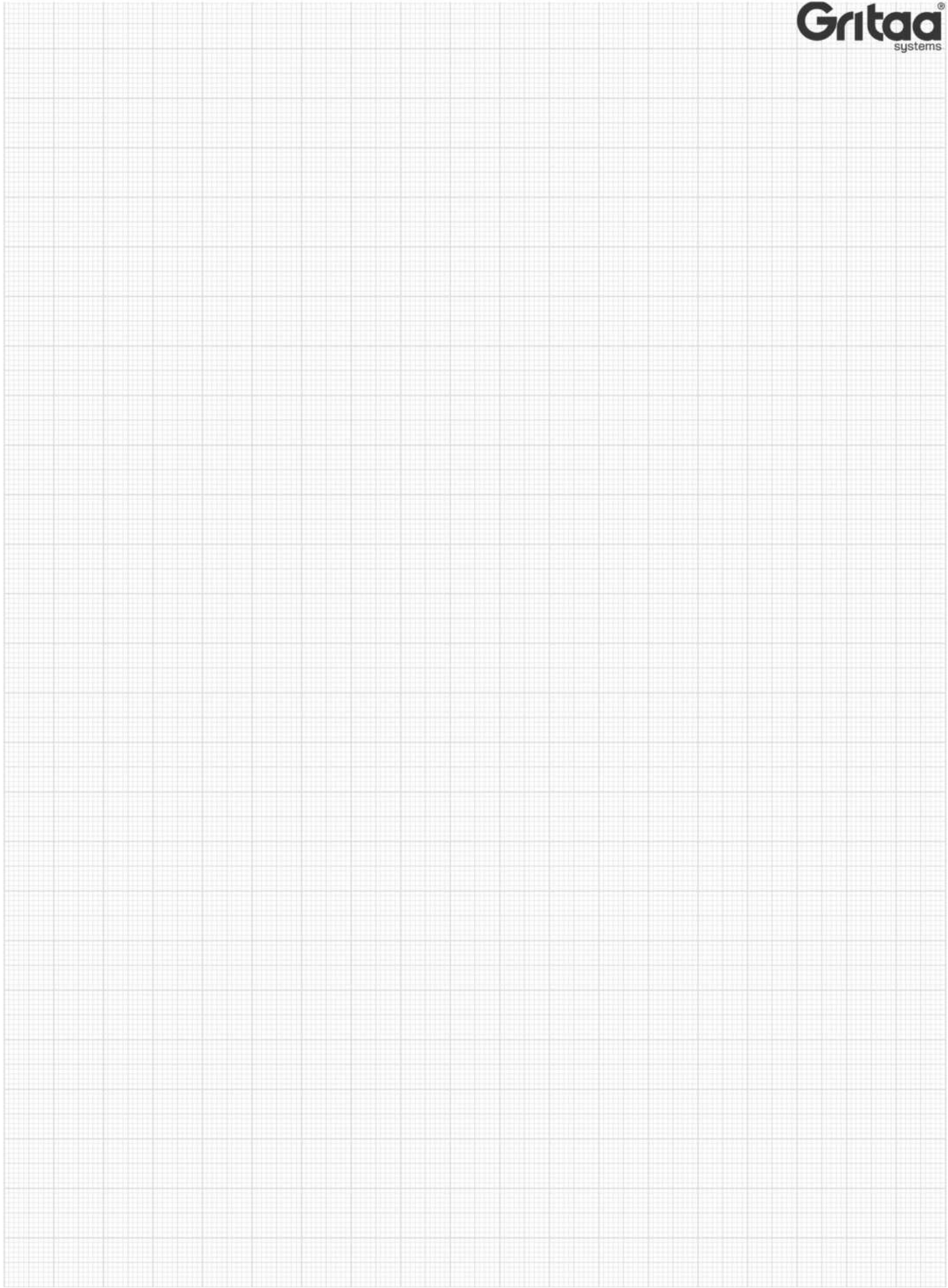

# THE END



SCAN ME!